

Two-Ply Self-Adhered and Heat-Welded Modified Bitumen Mineral-Surfaced Roofing System. For use over Johns Manville (JM) insulation, approved decks or other approved insulations on inclines up to 3" per ft (250 mm/m).

Materials per 100 ft² (9.29 m²) of roof area

Primer (if required): JM Concrete Primer	1 gal (3.8 l)
Base Ply:	
DynaGrip Base SD/SA	1/2 roll
Cap Sheet:	
DynaWeld Cap 180 FR	1 roll
DynaWeld Cap 250 FR	1 roll

General

This specification is for use over Invinso Roof Board, or other approved JM roof insulations which are not nailable and which provide a suitable surface to receive the roof. Specific written approval is required for any roof insulation that is not supplied by JM. Insulation should be installed in accordance with the appropriate JM insulation specification detailed in the JM Commercial/Industrial Roofing Systems Manual. This specification can also be used in certain re-roofing situations. Refer to the "Re-roofing" section of the JM Commercial/Industrial Roofing Systems Manual.

Design and installation of the deck and/or roof substrate must result in the roof draining freely, to outlets numerous enough and so located as to remove water promptly and completely. Areas where water ponds for more than 24 hours are unacceptable and will not be eligible for a JM Peak Advantage Guarantee.

Note: All general instructions contained in the current JM Commercial/Industrial Roofing Systems Manual shall be considered part of this specification.

Flashings

Flashing details can be found in Section 3 of the JM Commercial/Industrial Roofing Systems Manual.

Base Sheet Application

Starting at the low point of the roof, install a half-sheet-width piece of DynaGrip Base SD/SA over the approved substrate at the roof edge. Remove the bottom release film and roll-in the product to ensure full adhesion. Subsequent base sheets are to be applied in full width, with 4" (102 mm) side laps. Unroll the base sheet (cut to usable lengths) and allow to relax. Position the full-width base sheet, with the bottom film intact, so that the leading edge covers the 4" (102 mm) side lap of the previously installed base sheet and lines up with the perforated "go-to" line. Fold the full-width base sheet along its length and remove the release film from the 4" (102 mm) side lap of the half sheet and the corresponding release film from the bottom of the base sheet. Mate the two self-adhering surfaces from the center of the full-width base sheet to the sheet edge. Fold the other half of the base sheet back along its center and repeat the previous process. Roll the base sheet with a 75 lb to 100 lb (34 kg to 45 kg) split-wheel, weighted roller, being sure to roll across the width of the sheet first, then lengthwise, for full adhesion. The remaining base sheets are to be installed full width in the same manner.

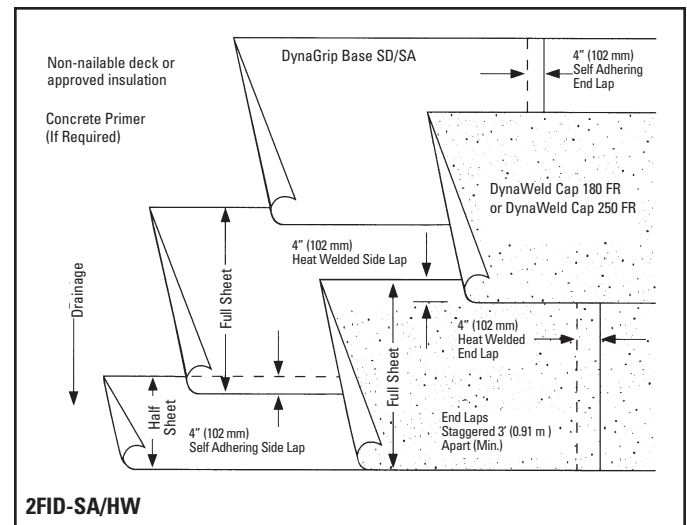

Cap Sheet Application

Heat weld a full width piece of one of the cap sheets listed over the installed base sheet. Subsequent sheets are to be applied in the same manner, with 4" (102 mm) side laps and 4" (102 mm) end laps over the preceding sheet.

Apply all sheets so that they are firmly and uniformly set, without voids. Using a propane torch, apply the flame to the surface of the coiled portion of the roll. Torch across the full width of the roll and along the lap area. As the surface is heated, it will develop a sheen and the burnoff will disappear. The generation of smoke is an indication that the material is being overheated. Repeat the operation with subsequent rolls, maintaining proper side laps and end laps. A healthy compound flow will simplify seaming the laps. This is done by keeping the flame directed at the adhered ply and in front of the roll. At the end laps, soften the bitumen by heating the granule surface with the torch. When the granules start to sink into the bitumen, stop torching and with a hot trowel, embed the granules into the bitumen. All laps must be checked for good adhesion.

For special precautions for heat-weld applications, see Paragraph 31.0 of Section 3d of the JM Commercial/Industrial Roofing Systems Manual.

For cold weather application techniques, refer to Paragraph 24.0 of Section 3d of the JM Commercial/Industrial Roofing Systems Manual.

Surfacing

No additional surfacing is required.

Steep Slope Requirements

Special procedures are required on inclines over ½" per foot (41 mm/m). Refer to Paragraph 21.0 of Section 3d of the JM Commercial/Industrial Roofing Systems Manual.

* Trumbull is a registered trademark of Owens Corning.

Refer to the Material Safety Data Sheet and product label prior to using this product.