

SUBSTRATE MUST BE PATCHED, LEVELED, AND PRIMED WITH PERMAFLASH PRIMER PRIOR TO APPLICATION OF PERMAFLASH.

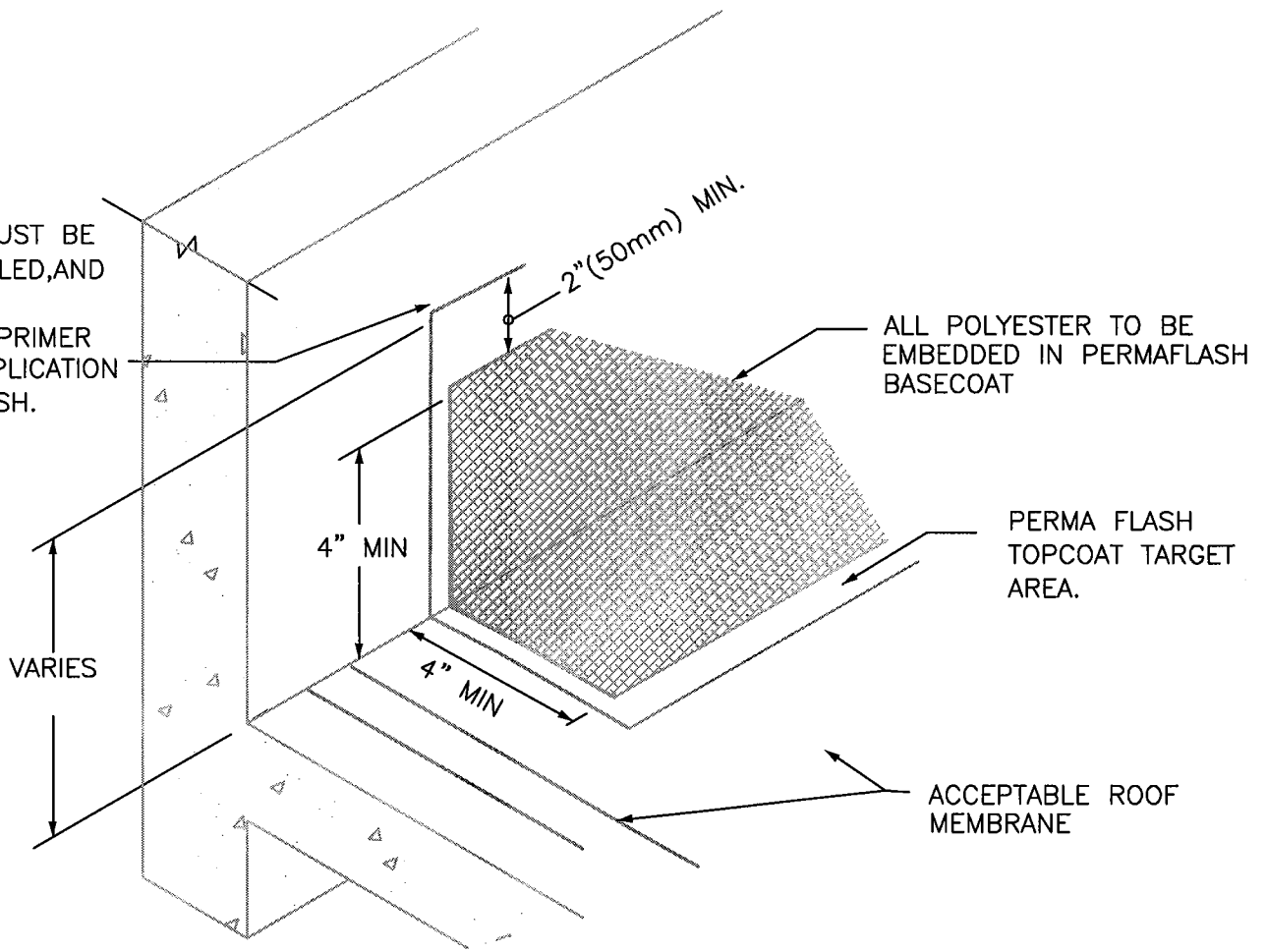

SPECIFICATION DFE-1(PF)



SCALE: NONE

PERMAFLASH BASE FLASHING FOR LOW WALL OR PARAPET CONSTRUCTION