

## Specification CBE-4

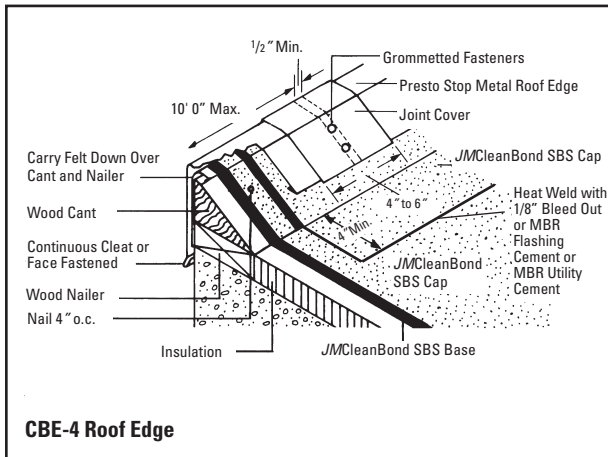

**CBE-4 Roof Edge**

### Roof Edge Details

#### Roof Edges and Gravel Stops

##### General

**Note:** All general instructions contained in the current JM Commercial/ Industrial Roofing Systems Manual shall be considered part of this specification.

##### Roof Edge Wood Cant

Prior to the installation of any metal edging, the *JMCleanBond*™ Base Sheet and Cap Sheet are carried up and secured to the wood cant with nails having a 1" (25 mm) head or disc at 4" (102 mm). Coat the cant and 4" (102 mm) into the field membrane with a layer of MBR flashing cement approximately 1/8" (3 mm) thick. Lay the *JMCleanBond* Cap into place on the cant and out onto the membrane a minimum of 4" (102 mm). The sheet should be worked in to ensure that it is firmly and uniformly bonded.

Heat welding techniques may also be employed to install the cap sheet. The *JMCleanBond* must be heat welded in areas where it comes into contact with a granulated surface. Prepare the area to be heat welded by removing any loose granules. Heat and embed all remaining granules with a hot air gun. Apply heat to the surface of the granulated cap sheet making sure to have good compound flow to adhere the two surfaces. All flashing areas must be rolled with a rounded edge roller. A 1/8" (3 mm) bleed out of SBS compound shall be visible at the edge of all seams.

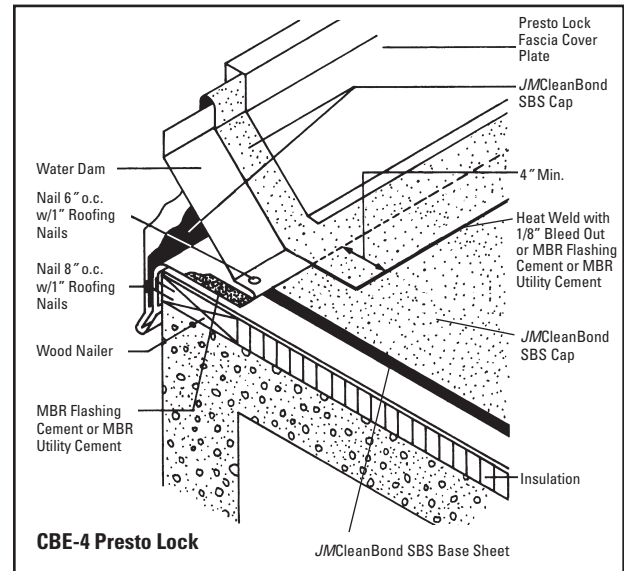

**CBE-4 Presto Lock**

Light gauge metals, such as copper, hot galvanized steel, or aluminum, shall be used for the edge metal. Refer to the Roofing Accessories section in the current Commercial/Industrial Roofing Systems Manual for manufacturer's recommendations on metal gauge, size, and cleat requirements, or in accordance with SMACNA procedures. The metal sections are secured to the wood cant with rubber-grommetted fasteners, at the center of the section and at the cover plates. The vertical face of the metal can be either held by a continuous cleat, or face fastened.

##### Presto Lock

When bonding self-adhering materials to metal, Johns Manville requires cleaning the metal to remove any oil, grease, etc. The metal surface receiving the flashing should then be coated with metal primer and allowed to dry.

##### Application

The *JMCleanBond* Base Sheet should run over the roof's edge and extend 1" (25 mm) beyond the nailer. Wood nailers must extend horizontally beyond the metal flange of the edge piece. Nailers must be pressure treated with a salt preservative. Install the Presto Lock® Fascia and Flashing System in accordance with the installation instructions provided with the product.