

Specification DGE-4

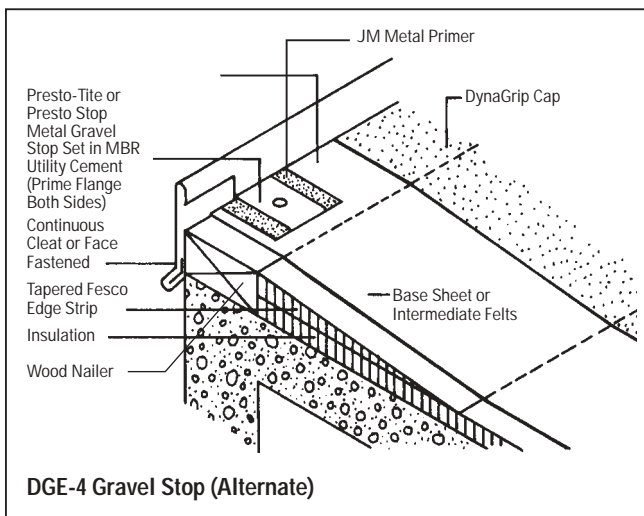
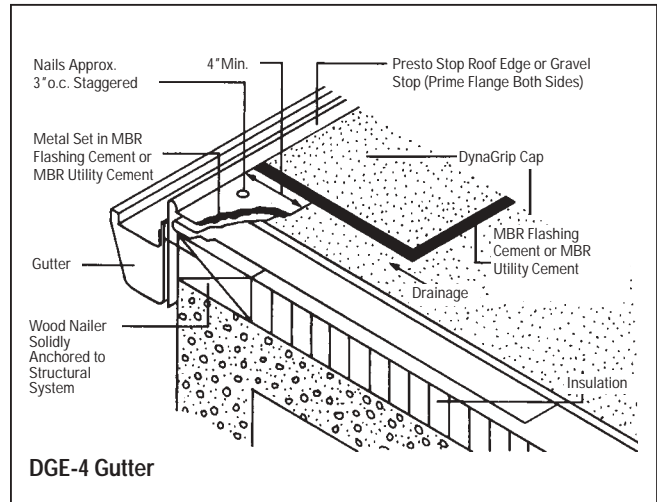
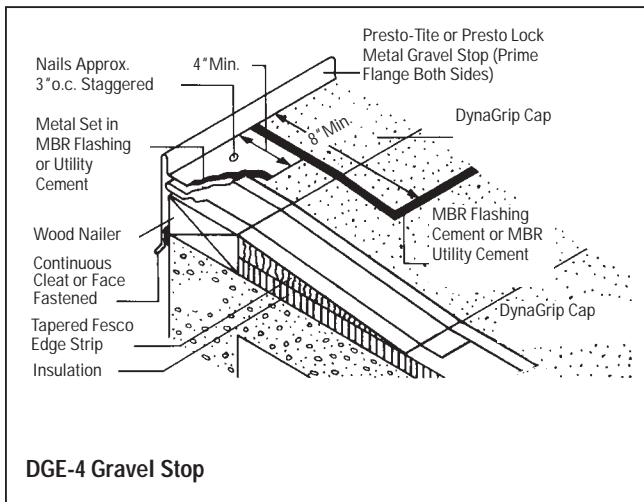

**Presto Stop Gravel Stop/Gutter**

Prior to the application of any metal edging, the membrane is carried up and secured to the wood nailer, with nails having a 1" (25 mm) head or disc, at 6" (152 mm) o.c. Wood nailers must extend horizontally beyond the metal flange of the edge piece. Nailers must be pressure treated with a salt preservative. Treatment of the nailers with creosote or asphaltic preservatives is not acceptable. The wood nailers must be solidly anchored to the structure.

Light gauge metals shall be used, such as copper, hot galvanized steel, or aluminum. Refer to the manufacturer's recommendations on metal gauge, size, and cleat requirements in Section 11 on Roofing Accessories, or in accordance with SMACNA procedures. The metal should be thoroughly cleaned to remove oil or other contaminants, and primed on both sides with JM Metal Primer, before applying the MBR Flashing Cement or MBR Utility Cement.

Set the metal sections into a 1/8" (3 mm) thick bed of MBR Flashing Cement or MBR Utility Cement, and fasten 3" (76 mm) o.c. on the horizontal flange, staggering the fasteners. The vertical face of the metal can be held either by a continuous cleat or face fastened. Strip in the metal edge with a minimum 8" (203 mm) wide piece of the modified bitumen membrane material, set in MBR Flashing Cement or MBR Utility Cement.

**Roof Edge Details**

**Roof edges and gravel stops**

**General**

The constructions shown are for use at the perimeter of the roof when no parapet exists.

This type of detail covers the junction between roof and exterior walls, provides a decorative fascia for the building, and (when required) acts as a gravel stop.

**Note:** All general instructions contained in the current JM Commercial/Industrial Roofing Systems Manual shall be considered part of this specification.

**Note:** Additional flashing requirements may be required for JM guarantee systems.

## Specification DGE-4

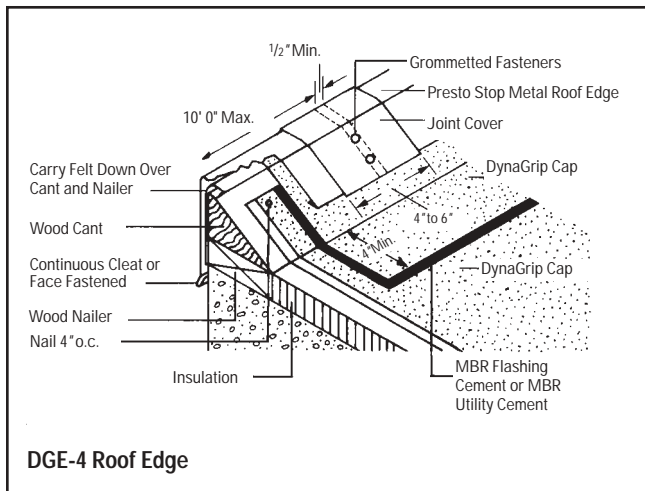

DGE-4 Roof Edge

### Roof Edge Details

#### Roof edges and gravel stops

##### General

**Note:** All general instructions contained in the current JM Commercial/Industrial Roofing Systems Manual shall be considered part of this specification.

##### Roof Edge

Prior to the application of any metal edging, the membrane is carried up and secured to the wood cant, with nails having a 1" (25 mm) head or disc, at 4" (102 mm) o.c. Wood nailers and cants must be pressure treated with a salt preservative. Treatment with creosote or asphaltic preservatives is not acceptable. The wood nailers and cants must be solidly anchored to the structure. Cut the DynaGrip™ Cap into sections that can be easily handled and installed (6' - 8' [1.83 m - 2.44 m]). Coat the cant and out onto the roof membrane with a layer of MBR Flashing Cement approximately 1/8" (3 mm) thick. Lay the DynaGrip Cap into place on the cant and out onto the membrane a minimum of 4" (102 mm). The sheet should be "worked-in" to ensure that it is firmly and uniformly bonded. The DynaGrip Cap may also be installed using MBR Flashing Cement or MBR Utility Cement. Mechanically fasten the DynaGrip Cap on 6" (152 mm) centers along the top edge. Fasteners must have 1" (25 mm) minimum integral caps, or be driven through 1" (25 mm) minimum rigid metal discs.

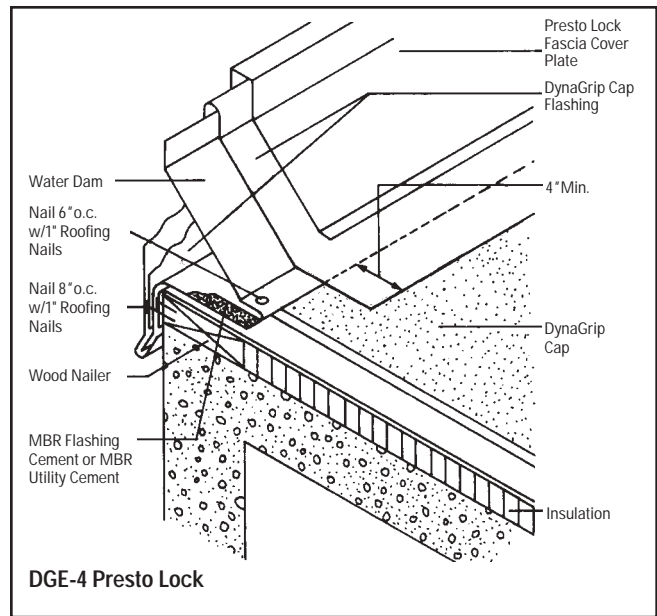

DGE-4 Presto Lock

Light gauge metals, such as copper, hot galvanized steel, or aluminum, shall be used for the edge metal. Refer to Section 11 on Roofing Accessories for manufacturer's recommendations on metal gauge, size, and cleat requirements, or in accordance with SMACNA procedures. The metal sections are secured to the wood cant with rubber-grommetted fasteners, at the center of the section and at the cover plates. The vertical face of the metal can be either held by a continuous cleat, or face fastened.

##### Presto Lock Fascia and Flashing System

Prior to the application of the Presto Lock, the membrane is secured to the wood nailer, with nails having a 1" (25 mm) head or disc, at 6" (152 mm) o.c. Wood nailers must extend horizontally beyond the metal flange of the edge piece. Nailers must be pressure treated with a salt preservative. Treatment of the nailers with creosote or asphaltic preservatives is not acceptable. The wood nailers must be solidly anchored to the structure.

Install the Presto Lock Fascia and Flashing System, in accordance with the installation instructions provided with the product.

**Note:** Additional flashing requirements may be required for JM guarantee systems.