

1/4" TO 1/2" (8 mm TO 16 mm)
 BEAD OF CAULKING IS
 REQUIRED BEHIND
 TERMINATION BAR
 WHEN HIGH
 INTERNAL PRESSURE
 IS ANTICIPATED

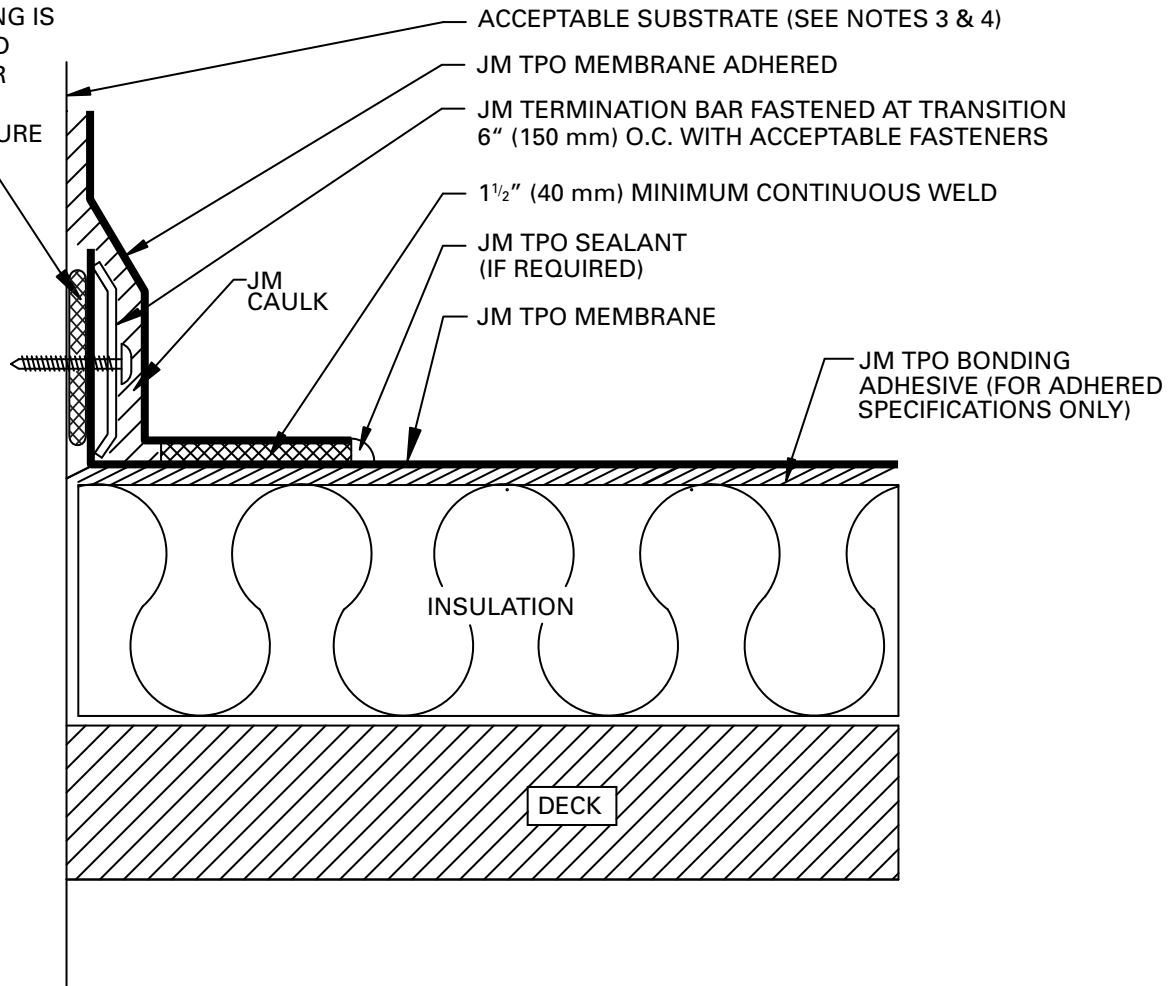

NOTES:

1. DETAILS TO BE USED IN CONJUNCTION WITH GUIDE SPECIFICATIONS CONTAINING REQUIREMENTS FOR NAILERS, INSULATION, SLIPSHEETS, ETC.
2. JM TPO SEALANT IS REQUIRED ON ALL CUT OR NON-ENCAPSULATED EDGES OF REINFORCED MEMBRANE. THIS INCLUDES FACTORY CUT MEMBRANE.
3. IN NEW CONSTRUCTION ACCEPTABLE SUBSTRATES INCLUDE EXTERIOR GRADE PLYWOOD, POURED OR PRECAST CONCRETE, CEMENT BLOCK OR MASONRY WALLS. CONTACT JM TECHNICAL SERVICES FOR OTHER SUBSTRATES.
4. ACCORDING TO PROJECT CONDITIONS, THE SPECIFIER AND/OR APPLICATOR MUST DETERMINE THAT THE VERTICAL SUBSTRATE/STRUCTURE IS ABLE TO RESIST 200 LBS./FT. (298 KGS./METER) MINIMUM IN ALL DIRECTIONS.
5. THE SPECIFIER AND/OR APPLICATOR MUST DETERMINE THAT THE VERTICAL SUBSTRATE/FASTENER COMBINATION WILL PROVIDE ADEQUATE PULL OUT VALUES IN EXCESS OF 200 LBS./FT. (298 KGS./METER).

DRAWING NO.

TB-26A

MEMBRANE FLASHING BASE TIE-IN

SCALE

N.T.S.

ISSUE DATE

3-06

CAD

TPO-26A

